

# Insta-Lock™ Coupling Systems

---



**Note: Continental ContiTech Insta-Lock™ fittings are never to be used in steam or compressed air service. Continental ContiTech Products Insta-Lock™ Cam Arms are designed exclusively for Insta-Lock™ fittings.**

**Warning: Dust Caps and Dust Plugs are not to be used in pressure applications for safety and environmental reasons.**

**ContiTech Insta-Lock™ products were formerly offered by Veyance Technology, the exclusive manufacturer of Goodyear Engineered Products.**

# INSTA-LOCK™ PRESSURE RATING CHART

Insta-Lock™ Pressure Rating Chart	
Size	PSI*
0.50"	250
0.75"	250
1.00"	250
1.25"	250
1.50"	250
2.00"	250
2.50"	150
3.00"	150
4.00"	150
5.00"	75
6.00"	75

\*Recommended working pressure ratings based on ambient temperature (70°F).

# Insta-Lock™ Type B Female Coupler X Male NPT Thread

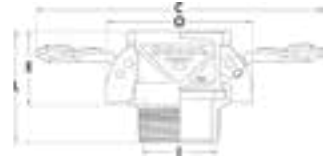

## Product Specifications

### Application

Type B fitting is normally threaded onto a pipe or manifold which joins to a rubber hose assembly that is connected and disconnected regularly. Insta-Lock™ fittings are designed for liquids and dry bulk. Consult the chemical resistance guide for specific chemical recommendations.

### Materials

Aluminum, 316# Stainless Steel and Brass

### Pressure Rating

Sizes 1/2"-2", 250 psi; sizes 2½"-4", 150 psi; sizes 5"-6", 75 psi. Recommended working pressure ratings based on ambient temperature 70°F (21°C) with Standard Nitrile gaskets.

### Branding

Example: Continental ContiTech B200SS

### Insta-Lock™ Type B Female Coupler X Male NPT Thread

Size	Aluminum	Stainless Steel	Brass
1/2	.5BSLALGD	.5BSLSSGD	.5BSLBRGD
3/4	.75BSLALGD	.75BSLSSGD	.75BSLBRGD
1	10BSLALGD	10BSLSSGD	10BSLBRGD
1¼	12BSLALGD	12BSLSSGD	12BSLBRGD
1½	15BSLALGD	15BSLSSGD	15BSLBRGD
2	20BSLALGD	20BSLSSGD	20BSLBRGD
2½	25BSLALGD	25BSLSSGD	25BSLBRGD
3	30BSLALGD	30BSLSSGD	30BSLBRGD
4	40BSLALGD	40BSLSSGD	40BSLBRGD
5	50BSLALGD	50BSLSSGD	50BSLBRGD
6	60BSLALGD	60BSLSSGD	60BSLBRGD

Size	Max. Width with Cam Arms Closed (O)	Overall Length (L)	Exposed Length (E)	Minimum ID (I)	Max. Width with Cam Arms Extended (C)
in.	in.	in.	in.	in.	in.
1/2	2.469	1.906	1.188	0.469	4.969
3/4	2.781	2.031	1.313	0.688	5.261
1	2.920	2.500	1.625	0.875	5.367
1¼	3.510	2.937	2.000	1.063	7.669
1½	3.830	2.937	2.000	1.375	7.967
2	4.210	3.218	2.156	1.750	8.340
2½	4.720	3.718	2.250	2.187	8.837
3	5.680	4.000	2.468	2.812	10.435
4	6.780	4.218	2.593	3.750	11.538
5	7.813	4.406	2.625	4.688	12.571
6	9.344	4.750	2.844	5.750	16.096

Note: Continental ContiTech Insta-Lock™ fittings are never to be used in steam or compressed air service. Continental ContiTech Products Insta-Lock™ Cam Arms are designed exclusively for Insta-Lock™ fittings.

# Insta-Lock™ Type C Female Coupler X Hose Shank

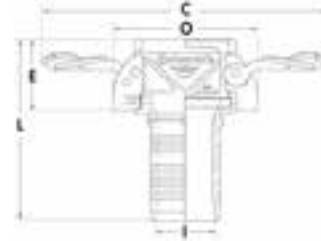

## Product Specifications

### Application

Type C fitting can be attached to a rubber hose with the use of interlocking ferrules, crimp sleeves, or bands. Insta-Lock™ fittings are designed for liquids and dry bulk. Consult the chemical resistance guide for specific chemical recommendations.

### Materials

Aluminum, 316# Stainless Steel and Brass

### Pressure Rating

Sizes 1/2"-2", 250 psi; sizes 2½"-4", 150 psi; sizes 5"-6", 75 psi. Recommended working pressure ratings based on ambient temperature 70°F (21°C) with Standard Nitrile gaskets.

### Branding

Example: Continental ContiTech C200SS

### Insta-Lock™ Type C Female Coupler X Hose Shank

Size	Aluminum	Stainless Steel	Brass
1/2	.5CSLALGD	.5CSLSSGD	.5CSLBRGD
3/4	.75CSLALGD	.75CSLSSGD	.75CSLBRGD
1	10CSLALGD	10CSLSSGD	10CSLBRGD
1¼	12CSLALGD	12CSLSSGD	12CSLBRGD
1½	15CSLALGD	15CSLSSGD	15CSLBRGD
2	20CSLALGD	20CSLSSGD	20CSLBRGD
2½	25CSLALGD	25CSLSSGD	25CSLBRGD
3	30CSLALGD	30CSLSSGD	30CSLBRGD
4	40CSLALGD	40CSLSSGD	40CSLBRGD
5	50CSLALGD	50CSLSSGD	50CSLBRGD
6	60CSLALGD	60CSLSSGD	60CSLBRGD

Size	Max. Width with Cam Arms Closed (O)	Overall Length (L)	Exposed Length (E)	Minimum ID (I)	Max. Width with Cam Arms Extended (C)
in.	in.	in.	in.	in.	in.
1/2	2.469	3.063	1.188	0.260	4.969
3/4	2.781	3.656	1.313	0.490	5.261
1	2.920	4.250	1.975	0.718	5.367
1¼	3.510	4.625	2.350	0.906	7.669
1½	3.830	4.750	2.370	1.156	7.967
2	4.210	5.281	2.531	1.625	8.340
2½	4.720	5.750	2.625	2.093	8.837
3	5.680	6.840	2.849	2.560	10.435
4	6.780	7.218	2.994	3.468	11.538
5	7.813	7.563	2.625	4.469	12.571
6	9.344	8.969	2.844	5.469	16.096

Note: Continental ContiTech Insta-Lock™ fittings are never to be used in steam or compressed air service. Continental ContiTech Products Insta-Lock™ Cam Arms are designed exclusively for Insta-Lock™ fittings.

# Insta-Lock™ Type D Female Coupler X Female NPT Thread

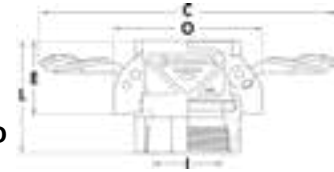

## Product Specifications

### Application

Type D fitting is commonly threaded onto a pipe, threaded hose end or manifold system, which is connected and disconnected on a regular basis. Insta-Lock™ fittings are designed for liquids and dry bulk. Consult the chemical resistance guide for specific chemical recommendations.

### Materials

Aluminum, 316# Stainless Steel and Brass

### Pressure Rating

Sizes 1/2"-2", 250 psi; sizes 2 1/2"-4", 150 psi; sizes 5"-6", 75 psi. Recommended working pressure ratings based on ambient temperature 70°F (21°C) with Standard Nitrile gaskets.

### Branding

Example: Continental ContiTech D200SS

### Insta-Lock™ Type D Female Coupler X Female NPT Thread

Size	Aluminum	Stainless Steel	Brass
1/2	.5DSLALGD	.5DSLSSGD	.5DSLBRGD
3/4	.75DSLALGD	.75DSLSSGD	.75DSLBRGD
1	10DSLALGD	10DSLSSGD	10DSLBRGD
1 1/4	12DSLALGD	12DSLSSGD	12DSLBRGD
1 1/2	15DSLALGD	15DSLSSGD	15DSLBRGD
2	20DSLALGD	20DSLSSGD	20DSLBRGD
2 1/2	25DSLALGD	25DSLSSGD	25DSLBRGD
3	30DSLALGD	30DSLSSGD	30DSLBRGD
4	40DSLALGD	40DSLSSGD	40DSLBRGD
5	50DSLALGD	50DSLSSGD	50DSLBRGD
6	60DSLALGD	60DSLSSGD	60DSLBRGD

Size	Max Width with CAM Arms Closed (O)	Overall Length (L)	Exposed Length (E)	Minimum ID (I)	Max Width with CAM Arms Extended (C)
in.	in.	in.	in.	in.	in.
1/2	2.469	1.813	1.188	0.656	4.969
3/4	2.781	2.063	1.313	0.813	5.261
1	2.920	2.375	1.975	1.000	5.367
1 1/4	3.510	2.687	2.350	1.300	7.669
1 1/2	3.830	2.843	2.370	1.560	7.967
2	4.210	3.156	2.531	1.937	8.340
2 1/2	4.720	3.437	2.625	2.312	8.837
3	5.680	3.718	2.849	2.937	10.435
4	6.780	4.030	2.994	3.750	11.538
5	7.813	4.313	2.563	4.688	12.571
6	9.344	4.513	2.719	5.750	16.096

Note: Continental ContiTech Insta-Lock™ fittings are never to be used in steam or compressed air service. Continental ContiTech Products Insta-Lock™ Cam Arms are designed exclusively for Insta-Lock™ fittings.

# Insta-Lock™ Type CXA and CXC Reducers and Double Females



## Insta-Lock™ Fittings - Reducers, Coupler x Coupler & Jump Sizes

Continental ContiTech SAP	Part Name	Description	Size	Material
in.	in.	in.	in.	in.
20668774	30CX20AALGD	Jump Size Female Coupler X Male Adapter	3 X 2	Aluminum
20668775	30CX40AALGD	Jump Size Female Coupler X Male Adapter	3 X 4	Aluminum
20668776	40CX30AALGD	Jump Size Female Coupler X Male Adapter	4 X 3	Aluminum
20668777	60CX40AALGD	Jump Size Female Coupler X Male Adapter	6 X 4	Aluminum
20668779	30CX30CALGD	Female Coupler X Female Coupler	3 X 3	Aluminum
20668780	40CX40CALGD	Female Coupler X Female Coupler	4 X 4	Aluminum

# Insta-Lock™ Type V - Dust Cap



## Product Specifications

### Application

Dust cap is used to seal the pipe system and hose assemblies during non-use or transfer of assembly. Mating parts are the Part A, Part E and Part F.

### Materials

Aluminum, 316# Stainless Steel and Brass (standard Nitrile gasket)

### Branding

Example: Continental ContiTech DC200SS

### Insta-Lock™ Dust Cap

Size	Aluminum	Stainless Steel	Brass
1/2	.5VSLALGD	.5VSLSSGD	.5VSLBRGD
3/4	.75VSLALGD	.75VSLSSGD	.75VSLBRGD
1	10VSLALGD	10VSLSSGD	10VSLBRGD
1¼	12VSLALGD	12VSLSSGD	12VSLBRGD
1½	15VSLALGD	15VSLSSGD	15VSLBRGD
2	20VSLALGD	20VSLSSGD	20VSLBRGD
2½	25VSLALGD	25VSLSSGD	25VSLBRGD
3	30VSLALGD	30VSLSSGD	30VSLBRGD
4	40VSLALGD	40VSLSSGD	40VSLBRGD
5	50VSLALGD	50VSLSSGD	50VSLBRGD
6	60VSLALGD	60VSLSSGD	60VSLBRGD

Size	Max. Width with Cam Arms Closed (O)	Overall Length (L)	OD with Cam Arms Extended (C)	Distance Chain Lug Extends from Body
in.	in.	in.	in.	in.
1/2	2.469	1.625	4.969	0.375
3/4	2.781	1.625	5.261	0.375
1	2.920	2.086	5.367	0.375
1¼	3.510	2.360	7.669	0.375
1½	3.830	2.400	7.967	0.375
2	4.210	2.633	8.340	0.375
2½	4.720	2.786	8.837	0.375
3	5.680	2.957	10.435	0.375
4	6.780	3.134	11.538	0.375
5	7.813	3.219	12.571	0.375
6	9.344	3.500	16.096	0.375

Note: Continental ContiTech Insta-Lock™ fittings are never to be used in steam or compressed air service. Continental ContiTech Insta-Lock™ Cam Arms are designed exclusively for Insta-Lock™ fittings.

Warning: Dust Caps and Dust Plugs are not to be used in pressure applications for safety and environmental reasons.

# Insta-Lock™ Repair Kits



## Product Specifications

### Application

316# Stainless Steel and Brass

### Materials

1 handle, 1 finger ring, 1 pin

### Insta-Lock™ Repair Kits

Size	Stainless Steel Handles	Brass Handles
in.	in.	in.
1/2	HBS05GD	N/A
3/4	HBS10GD	HB10GD
1	HBS10GD	HB10GD
1¼	HBS1215GD	HB1215GD
1½	HBS1215GD	HB1215GD
2	HBS2025GD	HB2025GD
2½	HBS2025GD	HB2025GD
3	HBS30GD	HB30GD
4	HBS30GD	HB30GD
5	HBS30GD	HB30GD
6	HBS60GD	HB60GD